WAINUIOMATA – BROOKFIELD PLACE NAME ORIGINS

Introduction

This document is about the origin of the names of various features at the Brookfield Outdoor Education Centre located at 562 Moores Valley Road, Wainuiomata.

Brookfield is named after a farm / house owned by John Eric Crowther (1831 – 1901) that was located at 562 Moores Valley Road, Moores Valley. It means a stream flows through open country. His daughter Mary Ursula Crowther (1869 – 1958) left the remnants of the farm to the Scouting Association when she died. The house was in existence from about 1865 to 1961.

Wainuiomata is named after the big water or stream of Mata. Wai means water. Nui means big. O means of. Mata refers to a woman's name Roimata. This is an official version. The origins of the word are disputed and other translations are:

- Refers to the women living in the now Hutt Valley who came over the Wainuiomata Hill to evade marauding Māori tribes. These tribes in about 1819 were carrying muskets that came north from the Paremata area. In the battle the local tribes were said to have been destroyed. The Paremata Māoris came across the remaining women who were sitting wailing by the stream after the slaughter of their menfolk. From this we have “faces streaming with water”, “tears” or “weeping water”.
- Refers to the large pools of water which lay over the swampy surface of the northern end of the Valley, or the river itself which is known to flood the Coast Road / Wainuiomata Valley. From this it can also mean large river from the swamp.
- Refers to a runaway called Mata who was pursued into the Wairarapa by a small party, some of who were killed by the Wairarapa local Māori tribe.
- Refers to the whitebait that are present at the mouth of the river. Mata means whitebait. From this we have big river of whitebait.
- Refers to flint or obsidian which is hard rock found in the headwaters of the river.
- Refers to the origin and personification of water.

Brookfield is owned by the Brookfield Outdoor Education Centre, which is owned by the Scouting Association. It has had various named over the years such as:

- Boy Scout Camp, Brookfield.
- Brookfield Activity Adventure Camp.
- Brookfield Scout Camp.
- Scout Camp Brookfield.

The area owned by the Brookfield Outdoor Education Centre is about 240 hectares.

This document is part of a series of the origin of place names of Wainuiomata.

For more information about Brookfield see the following books:

- In the Beginning – The History of Scouting in Wainuiomata 1910 – 1987 by Howard Clements.
- Mary Crowther of Brookfield by Vicky Alexander.

Also see the following web pages:

- <https://brookfield.scouts.nz/>
- <https://www.facebook.com/Brookfield.Outdoor.Education.Centre/>

Table Of Contents

Introduction 1
Table Of Contents 2
Brookfield Place Name Information 3
Brookfield Place Name Origins 4

Maps 8

Bibliography 10

Brookfield Place Name Information

The document is laid out in the following style:

Place name for example – Arthurs Bridge.

Type of feature for the place name for example – Bridge.

Definition of the place name for example – Arthur Raymond Ede (1939 – 2017) was a member of the Western Hills Lions Club. The organisation contributed time and money to build some facilities at Brookfield. The foot bridge goes over Crowther Creek.

Source of where the definition of the place name came from for example – Internet Search.

Time frame of when the place name came into existence for example – 1980s.

The tracks mentioned below go to the ridge on the south side of Brookfield.

The maps are in a separate section in this document.

See the Bibliography for further sources of information.

Brookfield Place Name Origins

Alcove, The

Field

A small field in the bush. It was a former grassy area when Mary Crowther was there.

Information – *Internet Search*. Time Frame – 1980s.

Arthurs Bridge

Bridge

Arthur Raymond Ede (1939 – 2017) was a member of the Western Hills Lions Club, Hutt Valley. The organisation contributed time and money to build some facilities at Brookfield. The foot bridge goes over Crowther Creek.

Information – *Internet Search*. Time Frame – 1980s.

Brookfield

Camp / Farm / House

Name of a farm / house by John Eric Crowther (1831 – 1901) that was located in the Moores Valley area. It means a stream flows through open country.

Information – *Internet Search*. Time Frame – 1860s.

Burn Paddock

Field

A kind of watercourse that is large stream or a small river. Crowther Creek is located in the area. It was a former grassy area when Mary Crowther was there.

Information – *Wikipedia*. Time Frame – 1980s.

Cameron Track

Track

John Mitchell Cameron (1914 – 1995) was a past Commissioner of the Hutt District and had other roles with the Scout Association. He was also active in the development of Brookfield.

Information – *Internet Search*. Time Frame – 2010s.

Campfire Track

Track

It goes to the Gordon McNair Campfire Circle which is built on the site of the Crowther homestead that was in existence from about 1865 to 1961.

Information – *Internet Search*. Time Frame – 1960s.

Chapel

Other

Chapel Track

Track

A place of Christian worship. It was erected in 1959.

Information – *Internet Search*. Time Frame – 1950s.

Crowther Creek

Water

Crowther Track

Track

Mary Ursula Crowther (1869 – 1958) was the owner of Brookfield who left it to the Scout Association when she died.

Information – *Internet Search*. Time Frame – 1980s.

Fletchers Hall

Building

The company Fletchers is a construction organisation. It was built by a group of apprentices. Their employer, Fletcher Construction, had difficulty finding work for them, so the company decided to donate their labour to the Scout Association.

Information – *Internet Search*. Time Frame – 1980s.

Gordon McNair Campfire Circle

Other

Gordon Andrew McNair (1906 – 1961) was the organiser of the first three Scout Gang Shows in Wellington whose profit helped build facilities at Brookfield. It is built on the site of the Crowther homestead that was in existence from about 1865 to 1961.

Information – *Internet Search*. Time Frame – 1960s.

Helicopter Paddock

Field

A type of rotorcraft in which lift and thrust are supplied by horizontally spinning rotors. This allows the helicopter to take off and land vertically, to hover, and to fly forward, backward and laterally. It was a former grassy area when Mary Crowther was there.

Information – *Wikipedia*. Time Frame – 1960s.

Johnstons Track

Track

Raymond Andrew Johnston (1936 – 2023) was the first resident camp warden at Brookfield. He is also a Life Member of the Scout Association.

Information – *Internet Search*. Time Frame – 1980s.

Kauri Campfire Circle

Other

A native tall coniferous forest tree that has broad leathery leaves, which produces valuable timber and resin. It is a giant amongst trees.

Information – *Internet Dictionary*. Time Frame – 1980s.

Lions Lodge

Building

An organisation when people join together and take action to make their community better.

Information – *Internet Search*. Time Frame – 1960s.

Lock Hut

Hut

Stephen (Steve) Lock (1942 – 2007) was a past Khandallah Group, Wellington and a National Scout.

Information – *Internet Search*. Time Frame – 2018.

Maire Lodge

Building

Maire Whare

Building

A tall native tree that has long, leathery leaves that have a recessed mid-rib. It was named after Roy Nelson (Royal Storygiert Cullen Gjerson) (1897 – 1988) who adopted the Māori Council of names. The whare was in existence from 1926 to the 1980s.

Information – *Internet Dictionary*. Time Frame – 1960s.

Meyer Track

Track

Hugh Philip Meyer (1919 – 2012) was a past Scout District Commission for the Hills District, Hutt Valley and had other roles with the Scout Association. He also served on the Brookfield Board. He helped maintain the water system at Brookfield.

Information – *Internet Search*. Time Frame – 2020.

Nelson Lounge

Building

Roy (Royal Storygiert Cullen Gjerson) (1897 – 1988) and Harold (Nils Harold Gjerson) (1890 – 1951) Nelson were brothers who had a friendship with Mary Ursula Crowther (1869 – 1958), who left the property to the Scout Association.

Information – *Internet Search*. Time Frame – 1960s.

Orchard Field

Field

A intentional plantation of fruit bearing trees that is maintained for food production. It was an area where John and his daughter Mary Crowther had their fruit growing area, so when it ripen the produce was for sale.

Information – *Internet Search*. Time Frame – 1890s.

Paddock, Bottom

Field

Paddock, Main

Field

Paddock, Top Right

Field

Paddock, Very Top

Field

The location of various grassy areas. They were also former grassy areas when Mary Crowther was there.

Information – *Internet Search*. Time Frame – 1920s.

Parade Field

Field

A area where cubs, scouts, rovers and rangers assembled and stand in rows.

Information – *Internet Search*. Time Frame – 1950s.

Pig Paddock

Field

An omnivorous domesticated hooved mammal with sparse bristly hair and a flat snout for rooting in the soil. There used to be a few wild pigs in the area. It was a former grassy area when Mary Crowther was there.

Information – *Internet Search*. Time Frame – 1920s.

Rovers Lodge

Building

A organisation for young adults 18 to 26 an opportunity to continue their Scouting or to join in with a group of active adventurers.

Information – *Internet Search*. Time Frame – 1960s.

Service Road

Track

A small road that gives access to the Brookfield water supply.

Information – *Internet Search*. Time Frame – 2000s.

Smiths Camp

Camp

Smiths Camp Track

Track

Ian Jack Smith (1937 – 2010) was a past Wellington Area Secretary of the Scout Association and had other roles with the Scout Association. He was also a Brookfield manager.

Information – *Internet Search*. Time Frame – 2000s.

Swanson Loop Track

Track

Kevin Anthony Swanson (1936 – 2017) was associated with the St Bernards Scout Group, Wainuiomata. He was also a Brookfield manager.

Information – *Internet Search*. Time Frame – 2000s.

Trap Line Track

Track

A route along which such a line of traps is set that is used to monitor and remove pest animals such as possums from the area.

Information – *Internet Search*. Time Frame – 2000s.

Wilson Track

Track

Leo Patrick Timothy Wilson (? - ?) was associated with the St Peters Scout Group, Wainuiomata.

Information – *Internet Search*. Time Frame – 2000s.

Worgun Loop Track

Track

John (Jack) Holder Bland Worgun (1925 – 2016) was associated with Brookfield.

Information – *Internet Search*. Time Frame – 2010s.

Brookfield Maps

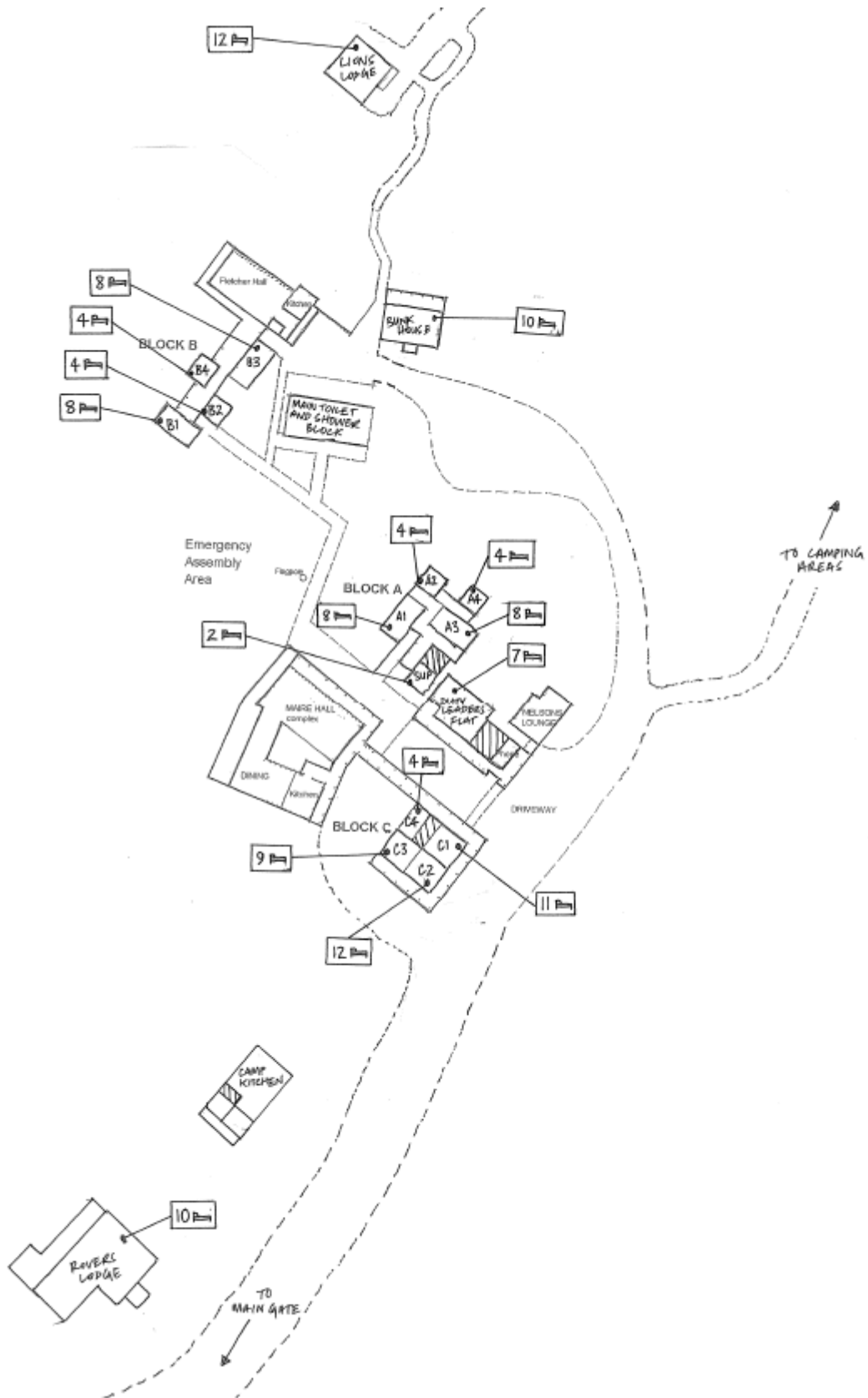

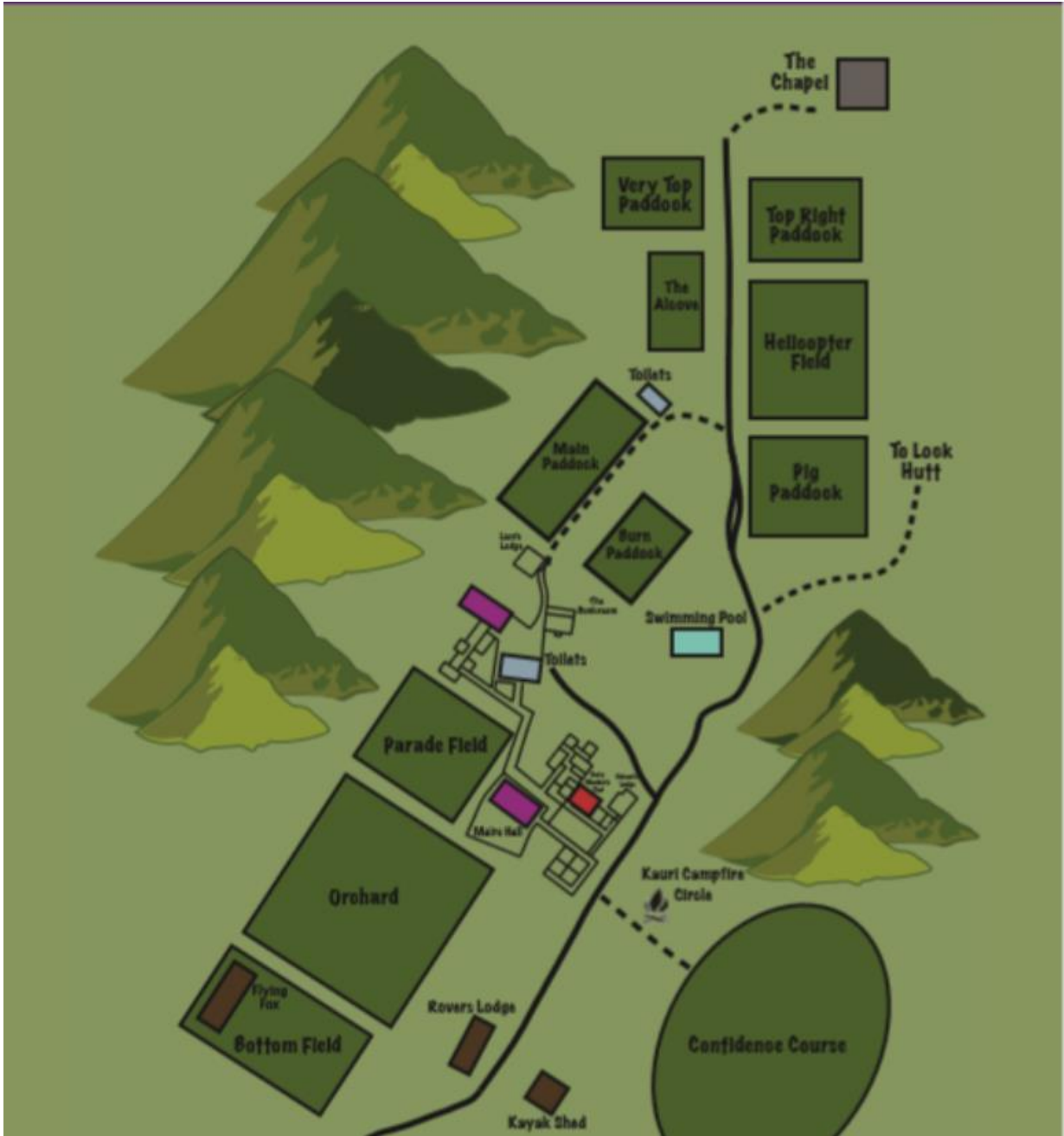

Source: Brookfield Outdoor Recreation Centre.

Bibliography

Maps

- Brookfield Map.
- Lower Hutt BQ32 Edition 1.08 2019.

Other Sources

Birth and Deaths dates have been obtained from:

- Birth, Death and Marriage Indexes from New Zealand, England and Ireland.
- Other genealogy sources such as Ancestry and Find My Past.

Other:

- Brookfield Outdoor Education Centre website.
- Facebook.
- Internet Dictionary.
- Internet Searches.
- Local Knowledge.
- Mapcarta website.
- New Zealand Electoral Rolls from the 1860s to present.
- Wikipedia.

Books

- Alexander, Vicky. Mary Crowther of Brookfield.
- Blayney, G. F. Early Education in Wainuiomata.
- Clements, Howard. In the Beginning – The History of Scouting in Wainuiomata 1910 – 1987.

Compiled by Jeremy Foster, December 2019.

Revised: 5 February 2024.

Printed: Tuesday, 6 February 2024.

Email: jjfoster@xtra.co.nz